

Contact Us: Call: (312) 800-8668 | Email: sales@dkcmail.com | Address: 1360 Landmeier Rd, Elk Grove Village, IL 60007

Customer Info:

Name: _____

Phone: _____

Email: _____

Address: _____

City: _____

State: _____ Zipcode: _____

	Door Style/Color	Panels Style/Color
Base		
Wall		
Island		

UNDERSTANDING YOUR KITCHEN SPACE:

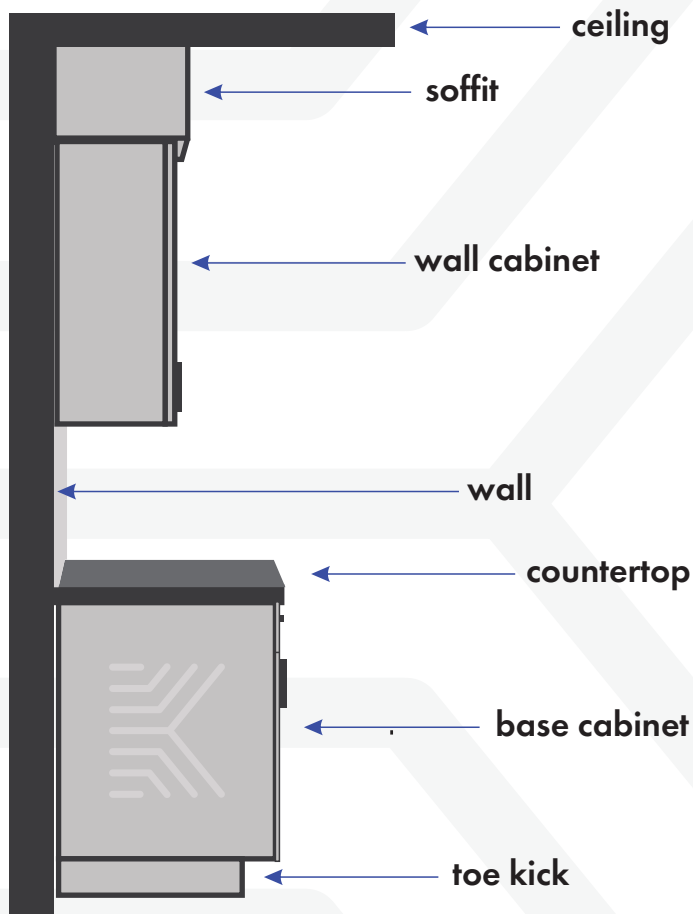

MEASURE YOUR SPACE:

Ceiling Height: _____ inch

Wall Cabinet Height (if known): _____ inch

Does Your Room have soffits
(the area between the top of the wall and the ceiling)?

Yes No

Do You Plan to Keep the Existing Soffits?

Yes No

If marked "YES" Please complete below:

Soffit Height: _____ inch (if applicable)

Soffit Depth: _____ inch (if applicable)

! NOTE: Please input those measurements in INCHES only. So 7'6" should be marked as 90".



PRO ADVICE: Measure ceiling height in 3 areas and record the shortest dimension

Contact Us: Call: (312) 800-8668 | Email: sales@dkcmail.com | Address: 1360 Landmeier Rd, Elk Grove Village, IL 60007

Customer Info: First Name: _____ Last Name: _____

STEP 1: DRAW AND MEASURE YOUR KITCHEN'S WALL AND OBSTACLES

- Use a pencil and the attached graph paper to design your new kitchen.
- Pick a corner to start. Then measure the full length of the wall.
- Continue around the whole room. When record the measurements give a name to the wall you are measure. **Example:** Wall A: 168", Wall B: 144"
- Locate and measure obstacles such as electrical outlets, vents, pipes, radiators, etc. **Example:** Electrical outlet 32" from wall C, 20" off the floor
- Record any islands you already have or wish to have (record the dimension on the grid)

Draw and name each wall on the grid and record the corresponding dimensions in the measurement chart on the right:

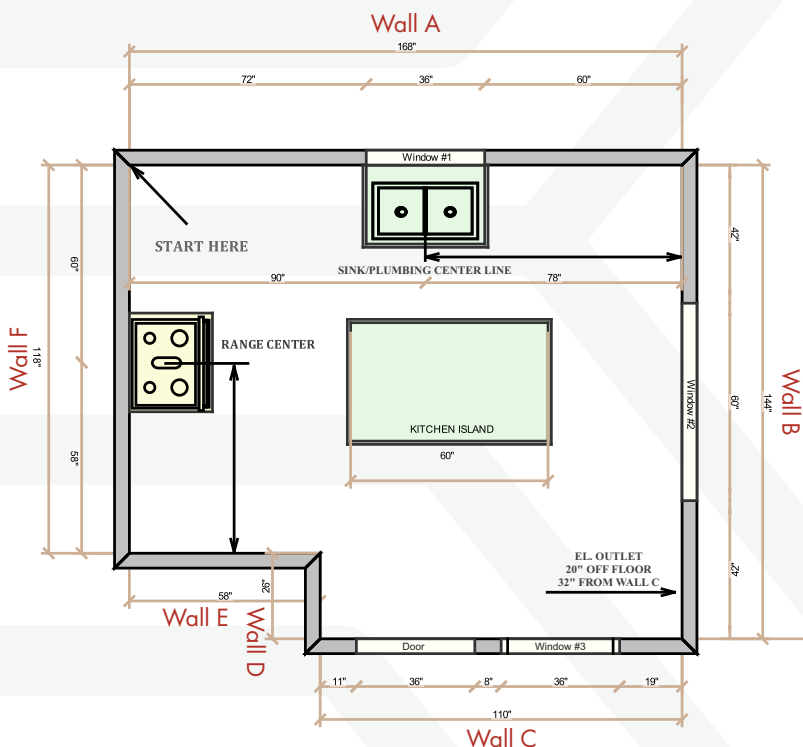

Wall Name	LENGTH in Inches
A	
B	
C	
D	
F	
E	
Island	

Contact Us: Call: (312) 800-8668 | Email: sales@dkcmail.com | Address: 1360 Landmeier Rd, Elk Grove Village, IL 60007

Customer Info: First Name: _____ Last Name: _____

STEP 2: WINDOWS, DOORS and APPLIANCES

- Locate and measure windows, doors and room openings.
- Measure all the windows, doors and room openings from outside trim edge to outside trim edge.
- Record and number each window and door on the grid and record the corresponding dimensions in the measurement charts on the right.

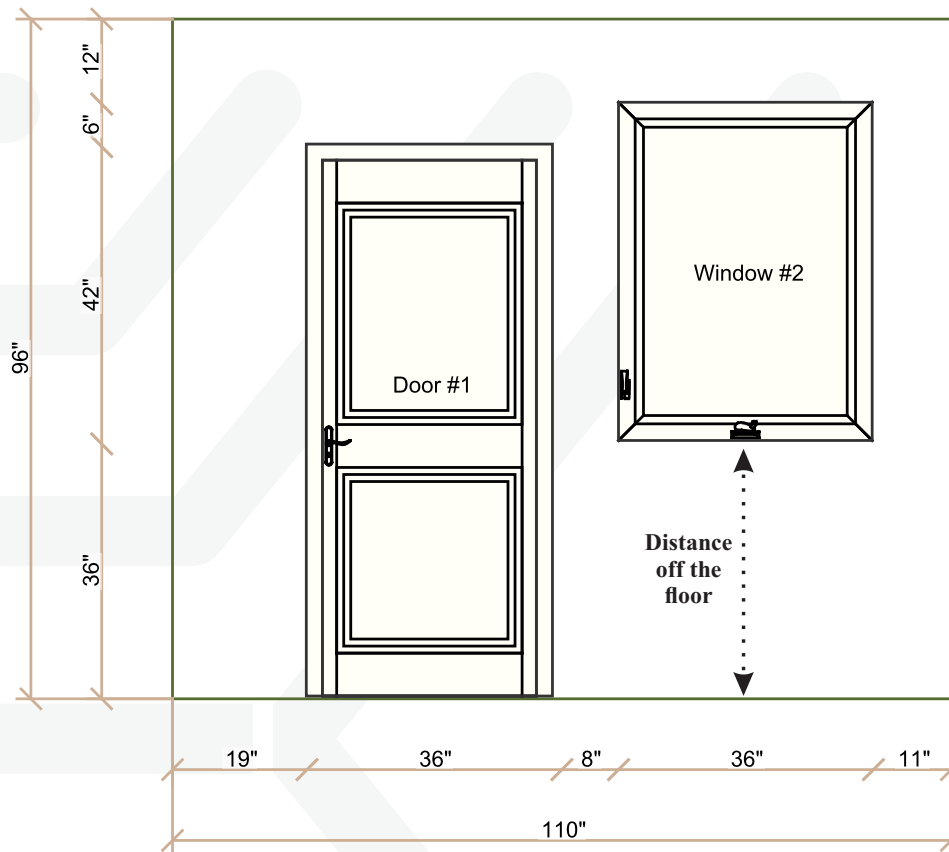

DOORS MEASUREMENTS*

*Label on the drawing using the corresponding numbers below

Wall Name	Door Name	Width	Height
	1		
	2		
	3		
	4		

WINDOWS MEASUREMENTS*

*Label on the drawing using the corresponding numbers below

Window Name	Width	Height	Distance off the Floor
1			
2			
3			
4			

Contact Us: Call: (312) 800-8668 | Email: sales@dkcmail.com | Address: 1360 Landmeier Rd, Elk Grove Village, IL 60007

Customer Info: First Name: _____ Last Name: _____

APPLIANCES

- Common appliances come in standard sizes but we need to know the exact measurements. Luxury appliances such as cooktops, range hoods, warming drawers, wine chillers and more, have dimensions that can vary drastically. If you have any Manufacturer Spec Sheets, please include them in your email along with your measuring guide.

TYPE APPLIANCE	Brand/Model	Width	Depth	Height
RANGE				
COOK-TOP				
OVEN				
HOOD				
MICROWAVE				
REFRIGERATOR				
DISHWASHER				
OTHER				

Please check any additional items you are interested in adding:

- | | | | |
|---|---|--|---------------------------------------|
| <input type="checkbox"/> Toe Kick/ Aluminum | <input type="checkbox"/> Garbage Pull Out Cabinet | <input type="checkbox"/> Microwave Upper Cabinet | <input type="checkbox"/> Wine Storage |
| <input type="checkbox"/> Top Cabinets Molding | <input type="checkbox"/> Glass Doors | <input type="checkbox"/> Open Shelves | <input type="checkbox"/> Wood Hood |
| <input type="checkbox"/> Crown Molding on The Ceiling | <input type="checkbox"/> Lazy Susan | <input type="checkbox"/> Plate Rack | |
| <input type="checkbox"/> Decorative Door Panels | <input type="checkbox"/> Light Rail Molding | <input type="checkbox"/> Roll Out Trays | |
| <input type="checkbox"/> Cutlery Divider | <input type="checkbox"/> Microwave Base Cabinet | <input type="checkbox"/> Spice Pull Out Cabinet | |

STEP 3: PHOTOS & SUBMIT

- It is time to make some photos of your current space. Make sure to include pictures of EACH WALL that will contain cabinets.



PRO ADVICE: Include photos of any special obstacles that you may have found difficult to include in your drawing.

- **SUBMIT:** Attach the measuring guide and pictures and email to sales@dkcmail.com



MEASURING GUIDE

Contact Us: Call: (312) 800-8668 | Email: sales@dkcmail.com | Address: 1360 Landmeier Rd, Elk Grove Village, IL 60007

Customer Info: *First Name:* _____ *Last Name:* _____

A large, empty grid of small squares, intended for drawing or measuring kitchen layouts. The grid is composed of 20 columns and 30 rows of squares.